

GENERAL SPECIFICATION – VESSEL

ITEM NO.: TK-801A,B SERVICE: ETHANOL PRODUCT SHIFT TANKS  
 CODE: API 650 STAMP: NO WELDING: ASME  
 RADIOGRAPH: NO STRESS RELIEVING: NO  
 DESIGN PRESSURE-PSIG (kPa): (SEE NOTE #7) TEMP.-°F (°C): 122 (50)  
 EST. WT. EMPTY-LB (kg): BY FAB. FULL WATER: BY FAB. OPERATING: BY FAB.  
 WIND VEL.-MPH (km/HR): (SEE NOTE #6) EARTHQUAKE ZONE: BY OWNER

PROCESS DATA

FLUID: ETHANOL DESIGN DENSITY-LB/FT<sup>3</sup> (kg/m<sup>3</sup>): 48.7 (780)  
 OPERATING PRESS.-PSIG (kPa): ATMOSPHERIC TEMP.-°F (°C): 100 (38)  
 HOLD-UP TIME: 8 HOURS APPROX. CAPACITY-GAL (L): 20,000 (76,000)  
 INLET RATE-GPM (m<sup>3</sup>/HR):- FLASH: NONE  
 NON-CONDENSIBLES: -

MATERIAL & THICKNESS-IN (mm)

SHELL: A285 GR.C CARBON STEEL  
 TOP HEAD: A285 GR.C CARBON STEEL  
 BOT. HEAD: A285 GR.C CARBON STEEL  
 SUPPORTS: NONE  
 BOLTS: A193 B7 W/ A194 2H HEX NUTS GASKETS: 2mm NON-ASBESTOS  
 NOZZLES: IN (mm)  
 NECK: A106 GR. B CARBON STEEL PIPE  
 FLANGE: A105 FORGED STEEL 150# SLIP-ON  
 COUPLING: A105 FORGED STEEL 3000# THREADED FULL  
 CORROSION ALLOWANCE: 2mm

NOZZLES

MARK	SERVICE	IN (mm)	NOTE
A	INLET	3"	FLANGED W/ INTERNAL DIP PIPE
B	OUTLET	4"	FLANGED W/ INTERNAL 90° ELBOW
C	LEVEL GAGING	6"	FLANGED VAREC SERIES 42-MODEL 42-6-112
D	MANWAY	24"	FLANGED W/ BLIND COVER & DAVIT
E	DRAIN	1"	COUPLING
F1,F2	LEVEL CONN.	3"	FLANGED (2) REQ'D.
G	BREATHER VENT	6"	FLANGED
H	INLET	3"	FLANGED W/ BLIND ON TK-801B
J	EMERGENCY VENT	8"	FLANGED
K	OVERFLOW	3"	FLANGED
L	MANWAY	20"	FLANGED W/ HINGED COVER

MISCELLANEOUS

LADDER: \_\_\_\_\_  
 PAINT: ALL EXTERNAL CARBON STEEL SURFACES TO BE CLEANED AND OTHERWISE PROPERLY PREPARED PRIOR TO APPLICATION OF ONE COAT OF CORROSION PROTECTION PRIMER PER SHOP STANDARD. FINAL PAINTING PER OWNER'S REQUIREMENTS.

- NOTES: 1. (2) TANKS REQUIRED.  
 2. ROOF AND FLOOR PLATES TO BE BUTT WELDED.  
 3. LAYOUT OF TK-801A,B REQUIRES NOZZLES 'K' TO FACE EACH OTHER.  
 4. FINAL ORIENTATION TO BE DETERMINED UPON FINAL PIPING DESIGN.  
 5. ALL DIMENSIONS ARE SHOWN IN MILLIMETERS UNLESS OTHERWISE NOTED.  
 6. 160 Km/h PER URUGUAYAN NORMATIVES: UNIT 50-84.  
 7. DESIGN PRESSURE: 1 PSIG (7 kPa) PLUS FULL STATIC HEAD OF LIQUID (S.G.=1.0)  
 DESIGN VACUUM: -0.5 PSIG (-3.5 kPa) WHEN TANK IS EMPTY.

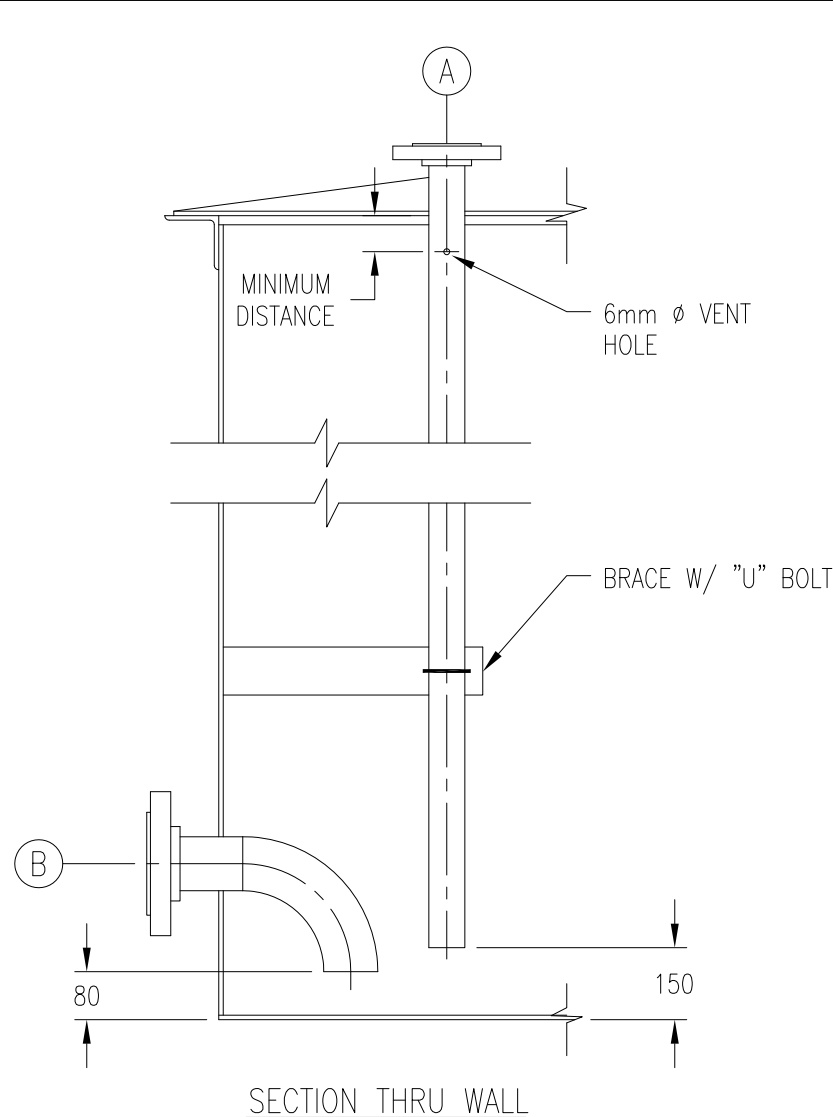

NOZZLE SIZE	NOZZLE ** EXTENSION
1 1/4"-6"	150
8"-24"	200

\*\* - UNLESS OTHERWISE SPECIFIED

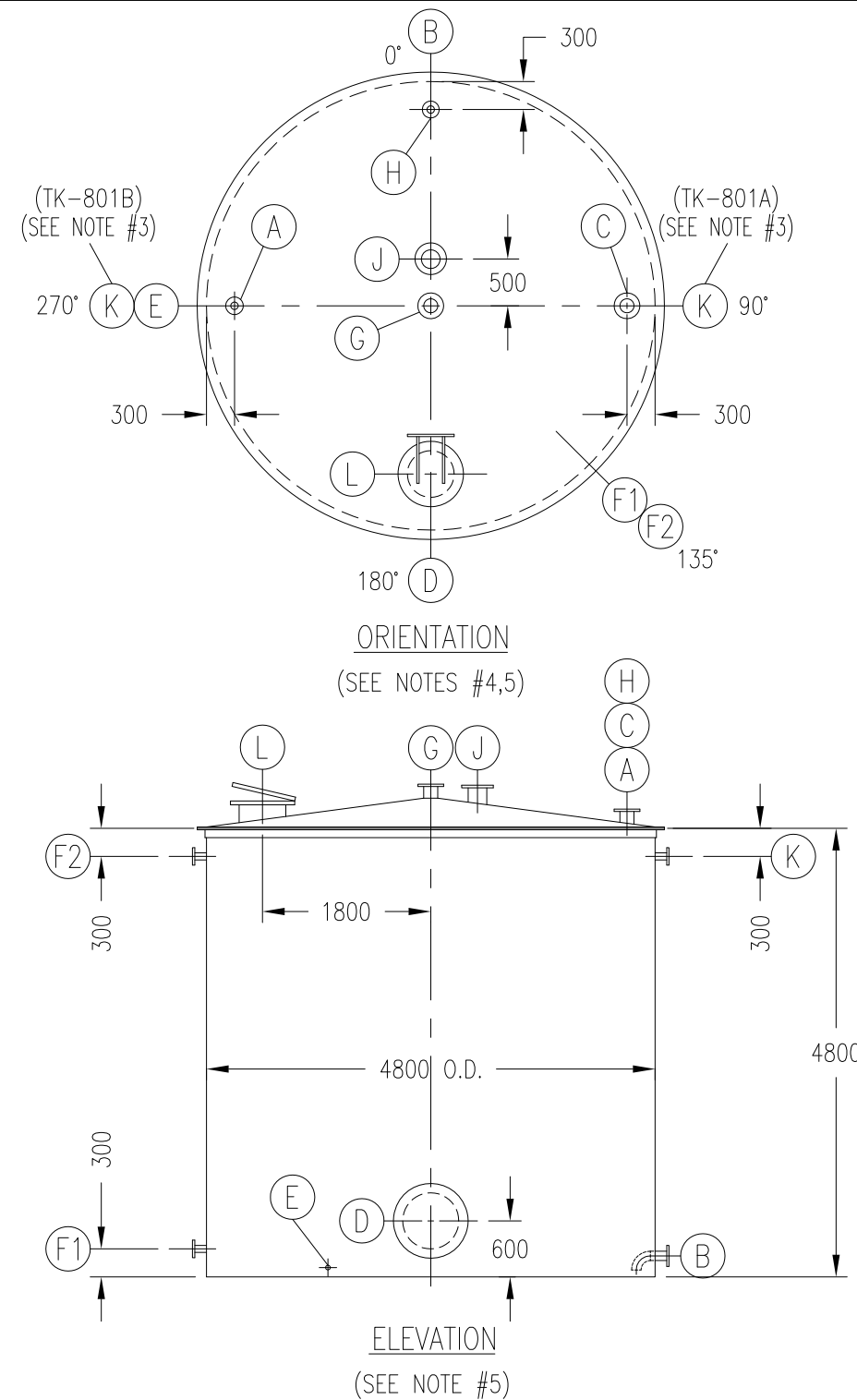

1. NOTICE: The process design and other information contained on this drawing is the confidential property of KATZEN INTERNATIONAL, INC. and is protected by confidentiality agreement, copyright law, and trade secret law, and may not be used, reproduced, discussed with, or disclosed to, any unauthorized persons or organizations in any manner or for any purpose, without prior written approval by an authorized representative of KATZEN INTERNATIONAL, INC.  
 2. KATZEN INTERNATIONAL, INC. is authorized to practice engineering in the state of Ohio, USA. All code requirements shall be reviewed by a person or persons licensed to practice engineering in the applicable jurisdiction, unless stipulated otherwise.

		<b>ALUR</b> ALCOHOLES DEL URUGUAY		<b>BIOETANOL PAYSANDÚ</b>	
		<b>UTE ABENER</b> <b>TEYMA PAYSANDÚ</b>		<b>KATZEN INTERNATIONAL, INC.</b> TECHNOLOGY • ENGINEERING CINCINNATI, OHIO, U.S.A.	
		Scale: NONE		211,200 LITERS/DAY MOTOR FUEL GRADE ETHANOL PLANT EQUIPMENT SPECIFICATION	
		REV. 0 ISSUE		Nº Plano: 0003-PLN-KAT-08-62-0201	
		WLB JDC JDC		Sheets: 1 Sheet Nº: 1	
		REV. 0		Client Nº: 1132-01 Dwg Nº: 08-201	
		Description		ITEM: TK-801A,B ETHANOL PRODUCT SHIFT TANKS	
		Dwn By Ckd By Appd By			
		Origin: JDC			